

FLANGE TYPE JIS B2220 - 5K

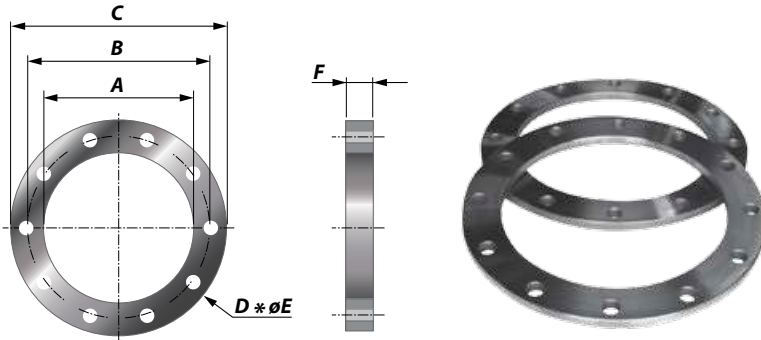

Article No.	Size (Inch)	NB (mm)	Pipe (mm)	A (mm)	B (mm)	C (mm)	D Number of holes	E Diameter of holes (mm)	F (mm)	Weight (kg)
212040100010	1	25	33.4	35	75	95	4	12	10	1
212040100013	1.25	32	42.2	43	90	115	4	15	12	1
212040100015	1.5	40	48.3	49	95	120	4	15	12	1
212040140020	2	50	60.3	61	105	130	4	15	14	1
212040140025	2.5	65	76.1	77	130	155	4	15	14	2
212040140030	3	80	88.9	90	145	180	4	19	14	2
212040160040	4	100	114.3	116	165	200	8	19	16	2
212040160050	5	125	139.7	142	200	235	8	19	16	3
212040180060	6	150	168.3	167	230	265	8	19	18	4
212040200080	8	200	219.1	218	280	320	8	23	20	6
212040220100	10	250	273.0	270	345	385	12	23	22	9
212040220120	12	300	323.9	321	390	430	12	23	22	10
212040240140	14	350	355.6	358	435	480	12	25	24	14
212040240160	16	400	406.4	409	495	540	16	25	24	17
212040240180	18	450	457.2	460	555	605	16	25	24	22
212040240200	20	500	508.0	511	605	655	20	25	24	23
212040260240	24	600	609.6	613	715	770	20	27	26	32
212040260280	28	700	711.2	715	820	875	24	27	26	38
212040280320	32	800	812.8	817	930	995	24	33	28	52
212040300360	36	900	914.4	919	1030	1095	24	33	30	61
212040320400	40	1000	1016.0	1021	1130	1195	28	33	32	71

CHARACTERISTICS

- Flanges** Hole pattern according type JIS Standard
- Material** Flanges are produced out of Steel S235JRG2
- Range** Diameter range from 33.4 mm up to 1016 mm
- Thickness** From minimum 10 mm up to maximum 32 mm
- Temperature** The maximum allowable temperature is 600°C

M-SIZES BOLTS & NUTS



M-sizes bolts & nuts vs. flange types & sizes

Size (Inch)	NB (mm)	Pipe (mm)	DIN2573 PN6	DIN2576 PN10	DIN86044	ANSI#150	JIS 5K	JIS 10K
1	25	33.4	M10 x 40	M12 x 40	-	M12 x 60	M10 x 40	M16 x 60
1.25	32	42.2	M12 x 50	M16 x 50	-	M12 x 60	M12 x 50	M16 x 60
1.5	40	48.3	M12 x 50	M16 x 50	-	M12 x 60	M12 x 50	M16 x 60
2	50	60.3	M12 x 50	M16 x 50	-	M16 x 60	M12 x 50	M16 x 60
2.5	65	76.1	M12 x 50	M16 x 50	-	M16 x 65	M12 x 50	M16 x 60
3	80	88.9	M16 x 60	M16 x 50	-	M16 x 65	M16 x 60	M16 x 60
4	100	114.3	M16 x 60	M16 x 50	-	M16 x 65	M16 x 60	M16 x 60
5	125	139.7	M16 x 60	M16 x 55	-	M20 x 70	M16 x 60	M20 x 70
6	150	168.3	M16 x 60	M20 x 60	-	M20 x 70	M16 x 60	M20 x 70
8	200	219.1	M16 x 60	M20 x 60	M20 x 60	M24 x 90	M20 x 70	M20 x 70
10	250	273.0	M16 x 60	M20 x 60	M20 x 60	M24 x 90	M20 x 70	M20 x 70
12	300	323.9	M20 x 60	M20 x 60	M20 x 60	M24 x 90	M20 x 70	M20 x 70
14	350	355.6	M20 x 60	M20 x 60	M20 x 60	M27 x 100	M24 x 80	M24 x 80
16	400	406.4	M20 x 60	M24 x 70	M20 x 60	M27 x 105	M24 x 80	M24 x 80
18	450	457.2	M20 x 60	M24 x 70	M20 x 60	M30 x 110	M24 x 80	M27 x 90
20	500	508.0	M20 x 60	M24 x 70	M20 x 60	M30 x 115	M24 x 80	M27 x 90
24	600	609.6	M24 x 70	M27 x 70	M20 x 70	-	M24 x 80	M30 x 105
28	700	711.2	M24 x 70	M27 x 70	M20 x 70	-	M24 x 80	M30 x 105
32	800	812.8	M27 x 75	M30 x 75	M20 x 70	-	M30 x 95	M30 x 105
36	900	914.4	M27 x 75	M30 x 75	M20 x 70	-	M30 x 95	M30 x 105
40	1000	1016.0	M27 x 75	M30 x 75	M20 x 70	-	M30 x 95	M36 x 120