

FLANGE TYPE JIS B2220 - 10K

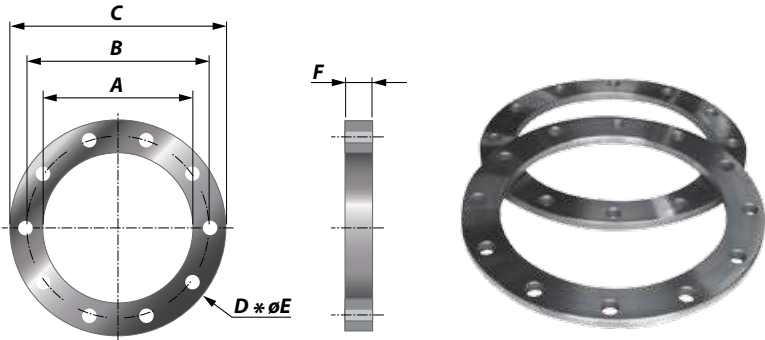

Article No.	Size (Inch)	NB (mm)	Pipe (mm)	A (mm)	B (mm)	C (mm)	D Number of holes	E Diameter of holes (mm)	F (mm)	Weight (kg)
212050140010	1	25	34.5	35	90	125	4	19	14	1
212050160013	1.25	32	43.2	43	100	135	4	19	16	2
212050160015	1.5	40	49.1	49	105	140	4	19	16	2
212050160020	2	50	61.1	61	120	155	4	19	16	2
212050180025	2.5	65	77.1	77	140	175	4	19	18	3
212050180030	3	80	90.0	90	150	185	8	19	18	3
212050180040	4	100	115.4	116	175	210	8	19	18	3
212050200050	5	125	141.2	142	210	250	8	23	20	5
212050220060	6	150	166.6	167	240	280	8	23	22	6
212050220080	8	200	218.0	218	290	330	12	23	22	8
212050240100	10	250	269.5	270	355	400	12	25	24	12
212050240120	12	300	321.0	321	400	445	16	25	24	14
212050260140	14	350	358.1	358	445	490	16	25	26	16
212050280160	16	400	409.0	409	510	560	16	27	28	23
212050300180	18	450	460.0	460	565	620	20	27	30	30
212050300200	20	500	511.0	511	620	675	20	27	30	34
212050320240	24	600	613.0	613	730	795	24	33	32	46
212050340280	28	700	715.0	715	840	905	24	33	34	60
212050360320	32	800	817.0	817	950	1020	28	33	36	76
212050380360	36	900	919.0	919	1050	1120	28	33	38	89
212050400400	40	1000	1021.0	1021	1160	1235	28	39	40	109

CHARACTERISTICS

Flanges Hole pattern according type JIS Standard

Material Flanges are produced out of Steel S235JRG2

Range Diameter range from 34.5 mm up to 1021 mm

Thickness From minimum 14 mm up to maximum 40 mm

Temperature The maximum allowable temperature is 600°C

M-SIZES BOLTS & NUTS



M-sizes bolts & nuts vs. flange types & sizes

Size (Inch)	NB (mm)	Pipe (mm)	DIN2573 PN6	DIN2576 PN10	DIN86044	ANSI#150	JIS 5K	JIS 10K
1	25	33.4	M10 x 40	M12 x 40	-	M12 x 60	M10 x 40	M16 x 60
1.25	32	42.2	M12 x 50	M16 x 50	-	M12 x 60	M12 x 50	M16 x 60
1.5	40	48.3	M12 x 50	M16 x 50	-	M12 x 60	M12 x 50	M16 x 60
2	50	60.3	M12 x 50	M16 x 50	-	M16 x 60	M12 x 50	M16 x 60
2.5	65	76.1	M12 x 50	M16 x 50	-	M16 x 65	M12 x 50	M16 x 60
3	80	88.9	M16 x 60	M16 x 50	-	M16 x 65	M16 x 60	M16 x 60
4	100	114.3	M16 x 60	M16 x 50	-	M16 x 65	M16 x 60	M16 x 60
5	125	139.7	M16 x 60	M16 x 55	-	M20 x 70	M16 x 60	M20 x 70
6	150	168.3	M16 x 60	M20 x 60	-	M20 x 70	M16 x 60	M20 x 70
8	200	219.1	M16 x 60	M20 x 60	M20 x 60	M24 x 90	M20 x 70	M20 x 70
10	250	273.0	M16 x 60	M20 x 60	M20 x 60	M24 x 90	M20 x 70	M20 x 70
12	300	323.9	M20 x 60	M20 x 60	M20 x 60	M24 x 90	M20 x 70	M20 x 70
14	350	355.6	M20 x 60	M20 x 60	M20 x 60	M27 x 100	M24 x 80	M24 x 80
16	400	406.4	M20 x 60	M24 x 70	M20 x 60	M27 x 105	M24 x 80	M24 x 80
18	450	457.2	M20 x 60	M24 x 70	M20 x 60	M30 x 110	M24 x 80	M27 x 90
20	500	508.0	M20 x 60	M24 x 70	M20 x 60	M30 x 115	M24 x 80	M27 x 90
24	600	609.6	M24 x 70	M27 x 70	M20 x 70	-	M24 x 80	M30 x 105
28	700	711.2	M24 x 70	M27 x 70	M20 x 70	-	M24 x 80	M30 x 105
32	800	812.8	M27 x 75	M30 x 75	M20 x 70	-	M30 x 95	M30 x 105
36	900	914.4	M27 x 75	M30 x 75	M20 x 70	-	M30 x 95	M30 x 105
40	1000	1016.0	M27 x 75	M30 x 75	M20 x 70	-	M30 x 95	M36 x 120