

FLANGE TYPE DIN 2576 - PN10

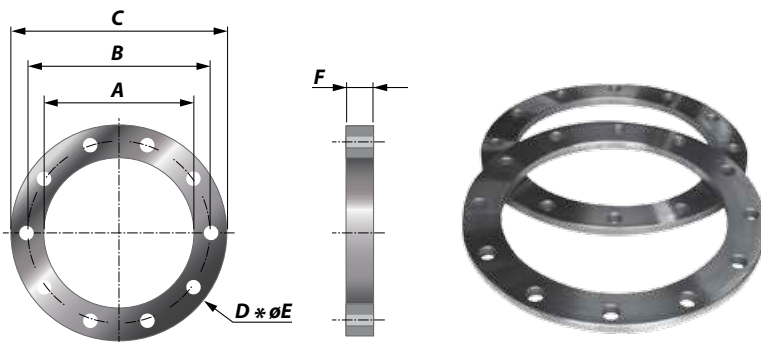

Article No.	Size (Inch)	NB (mm)	Pipe (mm)	A (mm)	B (mm)	C (mm)	D Number of holes	E Diameter of holes (mm)	F (mm)	Weight (kg)
212010120010	1	25	33.4	35	85	115	4	14	12	1
212010120013	1.25	32	42.2	43	100	140	4	18	12	1
212010120015	1.5	40	48.3	49	110	150	4	18	12	1
212010120020	2	50	60.3	61	125	165	4	18	12	2
212010120025	2.5	65	76.1	73	145	185	4	18	12	2
212010120030	3	80	88.9	90	160	200	4	18	12	2
212010120040	4	100	114.3	116	180	220	4	18	12	2
212010160050	5	125	139.7	142	210	250	8	18	16	4
212010160060	6	150	168.3	171	240	285	8	22	16	4
212010160080	8	200	219.1	222	295	340	8	22	16	5
212010160100	10	250	273.0	276	350	395	12	22	16	6
212010160120	12	300	323.9	327	400	445	12	22	16	8
212010200140	14	350	355.6	360	460	505	12	22	16	10
212010200160	16	400	406.4	411	515	565	16	26	16	11
212010200180	18	450	457.2	461	565	615	16	26	16	13
212010200200	20	500	508.0	512	620	670	20	26	16	14
212010200240	24	600	609.6	614	725	780	20	30	20	22
212010200280	28	700	711.2	716	840	895	24	30	20	25
212010200320	32	800	812.8	818	950	1015	24	33	20	31
212010200360	36	900	914.4	920	1050	1115	24	33	20	35
212010200400	40	1000	1016.0	1022	1160	1230	28	36	20	38

CHARACTERISTICS

Flanges Hole pattern according type DIN 2576 - PN10

Material Flanges are produced out of Steel S235JRG2

Range Diameter range from 33.4 mm up to 1016 mm

Thickness From minimum 12 mm up to maximum 20 mm

Temperature The maximum allowable temperature is 600°C

M-SIZES BOLTS & NUTS



M-sizes bolts & nuts vs. flange types & sizes

Size (Inch)	NB (mm)	Pipe (mm)	DIN2573 PN6	DIN2576 PN10	DIN86044	ANSI#150	JIS 5K	JIS 10K
1	25	33.4	M10 x 40	M12 x 40	-	M12 x 60	M10 x 40	M16 x 60
1.25	32	42.2	M12 x 50	M16 x 50	-	M12 x 60	M12 x 50	M16 x 60
1.5	40	48.3	M12 x 50	M16 x 50	-	M12 x 60	M12 x 50	M16 x 60
2	50	60.3	M12 x 50	M16 x 50	-	M16 x 60	M12 x 50	M16 x 60
2.5	65	76.1	M12 x 50	M16 x 50	-	M16 x 65	M12 x 50	M16 x 60
3	80	88.9	M16 x 60	M16 x 50	-	M16 x 65	M16 x 60	M16 x 60
4	100	114.3	M16 x 60	M16 x 50	-	M16 x 65	M16 x 60	M16 x 60
5	125	139.7	M16 x 60	M16 x 55	-	M20 x 70	M16 x 60	M20 x 70
6	150	168.3	M16 x 60	M20 x 60	-	M20 x 70	M16 x 60	M20 x 70
8	200	219.1	M16 x 60	M20 x 60	M20 x 60	M24 x 90	M20 x 70	M20 x 70
10	250	273.0	M16 x 60	M20 x 60	M20 x 60	M24 x 90	M20 x 70	M20 x 70
12	300	323.9	M20 x 60	M20 x 60	M20 x 60	M24 x 90	M20 x 70	M20 x 70
14	350	355.6	M20 x 60	M20 x 60	M20 x 60	M27 x 100	M24 x 80	M24 x 80
16	400	406.4	M20 x 60	M24 x 70	M20 x 60	M27 x 105	M24 x 80	M24 x 80
18	450	457.2	M20 x 60	M24 x 70	M20 x 60	M30 x 110	M24 x 80	M27 x 90
20	500	508.0	M20 x 60	M24 x 70	M20 x 60	M30 x 115	M24 x 80	M27 x 90
24	600	609.6	M24 x 70	M27 x 70	M20 x 70	-	M24 x 80	M30 x 105
28	700	711.2	M24 x 70	M27 x 70	M20 x 70	-	M24 x 80	M30 x 105
32	800	812.8	M27 x 75	M30 x 75	M20 x 70	-	M30 x 95	M30 x 105
36	900	914.4	M27 x 75	M30 x 75	M20 x 70	-	M30 x 95	M30 x 105
40	1000	1016.0	M27 x 75	M30 x 75	M20 x 70	-	M30 x 95	M36 x 120