

## FLANGE TYPE DIN 2573 - PN6

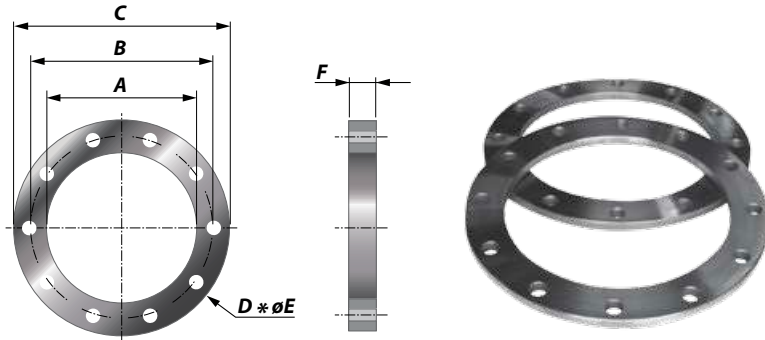

Article No.	Size (Inch)	NB (mm)	Pipe (mm)	A (mm)	B (mm)	C (mm)	D Number of holes	E Diameter of holes (mm)	F (mm)	Weight (kg)
212000120010	1	25	33.4	35	75	100	4	11	12	1
212000120013	1.25	32	42.2	43	90	120	4	14	12	1
212000120015	1.5	40	48.3	49	100	130	4	14	12	1
212000120020	2	50	60.3	61	110	140	4	14	12	2
212000120025	2.5	65	76.1	73	130	160	4	14	12	2
212000120030	3	80	88.9	90	150	190	4	18	12	2
212000120040	4	100	114.3	116	170	210	4	18	12	2
212000160050	5	125	139.7	142	200	240	8	18	16	4
212000160060	6	150	168.3	171	225	265	8	18	16	4
212000160080	8	200	219.1	222	280	320	8	18	16	5
212000160100	10	250	273.0	276	335	375	12	18	16	6
212000160120	12	300	323.9	327	395	440	12	22	16	8
212000160140	14	350	355.6	360	445	490	12	22	16	10
212000160160	16	400	406.4	411	495	540	16	22	16	11
212000160180	18	450	457.2	461	550	595	16	22	16	13
212000200200	20	500	508.0	512	600	645	20	22	16	14
212000200240	24	600	609.6	614	705	755	20	26	20	22
212000200280	28	700	711.2	716	810	860	24	26	20	25
212000200320	32	800	812.8	818	920	975	24	30	20	31
212000200360	36	900	914.4	920	1020	1075	24	30	20	35
212000200400	40	1000	1016.0	1022	1120	1022	28	30	20	38

### CHARACTERISTICS

**Flanges** Hole pattern according type DIN 2573 - PN6

**Material** Flanges are produced out of Steel S235JRG2

**Range** Diameter range from 33.4 mm up to 1016 mm

**Thickness** From minimum 12 mm up to maximum 20 mm

**Temperature** The maximum allowable temperature is 600°C

## M-SIZES BOLTS & NUTS



M-sizes bolts & nuts vs. flange types & sizes

Size (Inch)	NB (mm)	Pipe (mm)	DIN2573 PN6	DIN2576 PN10	DIN86044	ANSI#150	JIS 5K	JIS 10K
1	25	33.4	M10 x 40	M12 x 40	-	M12 x 60	M10 x 40	M16 x 60
1.25	32	42.2	M12 x 50	M16 x 50	-	M12 x 60	M12 x 50	M16 x 60
1.5	40	48.3	M12 x 50	M16 x 50	-	M12 x 60	M12 x 50	M16 x 60
2	50	60.3	M12 x 50	M16 x 50	-	M16 x 60	M12 x 50	M16 x 60
2.5	65	76.1	M12 x 50	M16 x 50	-	M16 x 65	M12 x 50	M16 x 60
3	80	88.9	M16 x 60	M16 x 50	-	M16 x 65	M16 x 60	M16 x 60
4	100	114.3	M16 x 60	M16 x 50	-	M16 x 65	M16 x 60	M16 x 60
5	125	139.7	M16 x 60	M16 x 55	-	M20 x 70	M16 x 60	M20 x 70
6	150	168.3	M16 x 60	M20 x 60	-	M20 x 70	M16 x 60	M20 x 70
8	200	219.1	M16 x 60	M20 x 60	M20 x 60	M24 x 90	M20 x 70	M20 x 70
10	250	273.0	M16 x 60	M20 x 60	M20 x 60	M24 x 90	M20 x 70	M20 x 70
12	300	323.9	M20 x 60	M20 x 60	M20 x 60	M24 x 90	M20 x 70	M20 x 70
14	350	355.6	M20 x 60	M20 x 60	M20 x 60	M27 x 100	M24 x 80	M24 x 80
16	400	406.4	M20 x 60	M24 x 70	M20 x 60	M27 x 105	M24 x 80	M24 x 80
18	450	457.2	M20 x 60	M24 x 70	M20 x 60	M30 x 110	M24 x 80	M27 x 90
20	500	508.0	M20 x 60	M24 x 70	M20 x 60	M30 x 115	M24 x 80	M27 x 90
24	600	609.6	M24 x 70	M27 x 70	M20 x 70	-	M24 x 80	M30 x 105
28	700	711.2	M24 x 70	M27 x 70	M20 x 70	-	M24 x 80	M30 x 105
32	800	812.8	M27 x 75	M30 x 75	M20 x 70	-	M30 x 95	M30 x 105
36	900	914.4	M27 x 75	M30 x 75	M20 x 70	-	M30 x 95	M30 x 105
40	1000	1016.0	M27 x 75	M30 x 75	M20 x 70	-	M30 x 95	M36 x 120