

FLANGE TYPE ANSI 150

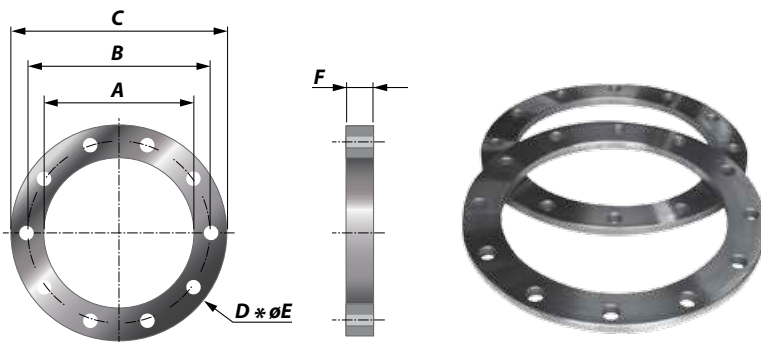

Article No.	Size (Inch)	NB (mm)	Pipe (mm)	A (mm)	B (mm)	C (mm)	D Number of holes	E Diameter of holes (mm)	F (mm)	Weight (kg)
212030150010	1	25	33.4	35	79	110	4	16	15	1
212030160013	1.25	32	42.2	43	89	120	4	16	16	1
212030180015	1.5	40	48.3	49	99	130	4	16	18	1
212030200020	2	50	60.3	61	121	150	4	19	20	2
212030230025	2.5	65	76.1	73	140	180	4	19	23	4
212030240030	3	80	88.9	90	153	190	4	19	24	4
212030240040	4	100	114.3	116	191	230	8	19	24	6
212030240050	5	125	139.7	142	216	255	8	22	24	6
212030260060	6	150	168.3	171	242	280	8	22	26	8
212030290080	8	200	219.1	222	299	345	8	22	29	13
212030310100	10	250	273.0	276	362	405	12	26	31	17
212030320120	12	300	323.9	327	432	485	12	26	32	27
212030350140	14	350	355.6	360	476	535	12	30	35	35
212030370160	16	400	406.4	411	540	600	16	30	37	42
212030400180	18	450	457.2	461	578	635	16	33	40	53
212030430200	20	500	508.0	512	635	700	20	33	43	65
212030480240	24	600	609.6	614	750	815	20	36	48	92

CHARACTERISTICS

Flanges Hole pattern according type ANSI 150 Standard

Material Flanges are produced out of Steel S235JRG2

Range Diameter range from 33.4 mm up to 609.6 mm

Thickness From minimum 15 mm up to maximum 48 mm

Temperature The maximum allowable temperature is 600°C

M-SIZES BOLTS & NUTS



M-sizes bolts & nuts vs. flange types & sizes

Size (Inch)	NB (mm)	Pipe (mm)	DIN2573 PN6	DIN2576 PN10	DIN86044	ANSI#150	JIS 5K	JIS 10K
1	25	33.4	M10 x 40	M12 x 40	-	M12 x 60	M10 x 40	M16 x 60
1.25	32	42.2	M12 x 50	M16 x 50	-	M12 x 60	M12 x 50	M16 x 60
1.5	40	48.3	M12 x 50	M16 x 50	-	M12 x 60	M12 x 50	M16 x 60
2	50	60.3	M12 x 50	M16 x 50	-	M16 x 60	M12 x 50	M16 x 60
2.5	65	76.1	M12 x 50	M16 x 50	-	M16 x 65	M12 x 50	M16 x 60
3	80	88.9	M16 x 60	M16 x 50	-	M16 x 65	M16 x 60	M16 x 60
4	100	114.3	M16 x 60	M16 x 50	-	M16 x 65	M16 x 60	M16 x 60
5	125	139.7	M16 x 60	M16 x 55	-	M20 x 70	M16 x 60	M20 x 70
6	150	168.3	M16 x 60	M20 x 60	-	M20 x 70	M16 x 60	M20 x 70
8	200	219.1	M16 x 60	M20 x 60	M20 x 60	M24 x 90	M20 x 70	M20 x 70
10	250	273.0	M16 x 60	M20 x 60	M20 x 60	M24 x 90	M20 x 70	M20 x 70
12	300	323.9	M20 x 60	M20 x 60	M20 x 60	M24 x 90	M20 x 70	M20 x 70
14	350	355.6	M20 x 60	M20 x 60	M20 x 60	M27 x 100	M24 x 80	M24 x 80
16	400	406.4	M20 x 60	M24 x 70	M20 x 60	M27 x 105	M24 x 80	M24 x 80
18	450	457.2	M20 x 60	M24 x 70	M20 x 60	M30 x 110	M24 x 80	M27 x 90
20	500	508.0	M20 x 60	M24 x 70	M20 x 60	M30 x 115	M24 x 80	M27 x 90
24	600	609.6	M24 x 70	M27 x 70	M20 x 70	-	M24 x 80	M30 x 105
28	700	711.2	M24 x 70	M27 x 70	M20 x 70	-	M24 x 80	M30 x 105
32	800	812.8	M27 x 75	M30 x 75	M20 x 70	-	M30 x 95	M30 x 105
36	900	914.4	M27 x 75	M30 x 75	M20 x 70	-	M30 x 95	M30 x 105
40	1000	1016.0	M27 x 75	M30 x 75	M20 x 70	-	M30 x 95	M36 x 120