

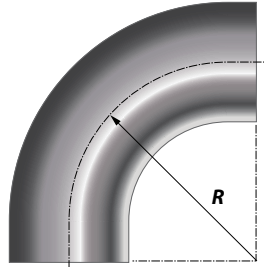

**PIPING**





## ELBOWS LONG RADIUS

Article No.	A Size (Inch)	NB (mm)	Pipe (mm)	R (mm)	Wall Thickness	
					S235JR (mm)	Stainless Steel (mm)
51030000020	2	50	60.3	135	2.9	2
51030000025	2.5	65	76.1	175	2.9	2
51030000030	3	80	88.9	205	3.2	2
51030000040	4	100	114.3	270	3.6	2
51030000050	5	125	139.7	330	4.0	3
51030000060	6	150	168.3	390	4.0	3

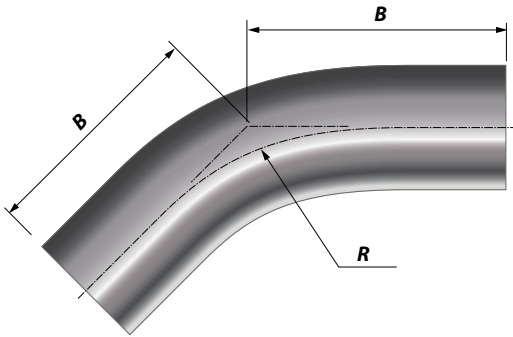

## ELBOWS LONG RADIUS 45°

Article No.	A Size (Inch)	NB (mm)	Pipe (mm)	B (mm)	R (mm)	Wall Thickness	
						S235JR (mm)	Stainless Steel (mm)
51040000020	2	50	60.3	56	135	2.9	2
51040000025	2.5	65	76.1	73	175	2.9	2
51040000030	3	80	88.9	85	205	3.2	2
51040000040	4	100	114.3	112	270	3.6	2
51040000050	5	125	139.7	137	330	4.0	3
51040000060	6	150	168.3	162	390	4.0	3

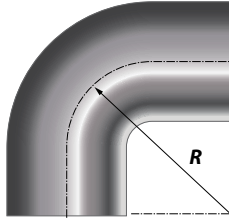

## ELBOWS SHORT RADIUS

Article No.	A Size (Inch)	NB (mm)	Pipe (mm)	R (mm)	Wall Thickness	
					S235JR (mm)	Stainless Steel (mm)
510500000020	2	50	60.3	76	2.9	2
510500000025	2.5	65	76.1	95	2.9	2
510500000030	3	80	88.9	114	3.2	2
510500000040	4	100	114.3	152	3.6	2
510500000050	5	125	139.7	190	4.0	3
510500000060	6	150	168.3	229	4.5	3
510500000080	8	200	219.1	309	6.3	3
510500000100	10	250	273.0	381	6.3	3
510500000120	12	300	323.9	457	7.1	3

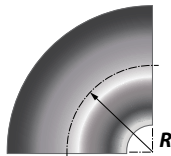

## ELBOWS SHORT RADIUS TANGENT CUT

Article No.	A Size (Inch)	NB (mm)	Pipe (mm)	R (mm)	Wall Thickness	
					S235JR (mm)	Stainless Steel (mm)
510600000020	2	50	60.3	51	2.9	2
510600000025	2.5	65	76.1	63	2.9	2
510600000030	3	80	88.9	76	3.2	2
510600000040	4	100	114.3	102	3.6	2
510600000050	5	125	139.7	127	4.0	3
510600000060	6	150	168.3	152	4.5	3
510600000080	8	200	219.1	203	6.3	3
510600000100	10	250	273.0	254	6.3	3
510600000120	12	300	323.9	305	7.1	3

# AXCES EXHAUST PIPING

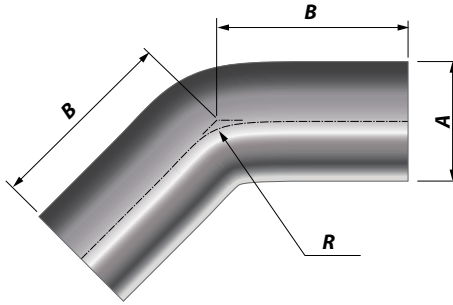

## ELBOWS SHORT RADIUS 45°

Article No.	A Size (Inch)	NB (mm)	Pipe (mm)	B (mm)	R (mm)	Wall Thickness	
						S235JR (mm)	Stainless Steel (mm)
510700000020	2	50	60.3	32	76	2.9	2
510700000025	2.5	65	76.1	40	95	2.9	2
510700000030	3	80	88.9	47	124	3.2	2
510700000040	4	100	114.3	63	152	3.6	2
510700000050	5	125	139.7	75	190	4.0	3
510700000060	6	150	168.3	95	229	4.5	3

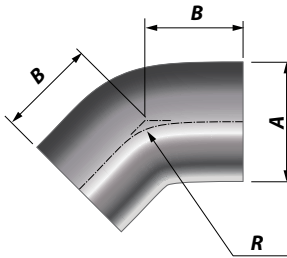

## ELBOWS SHORT RADIUS 45° TANGENT CUT

Article No.	A Size (Inch)	NB (mm)	Pipe (mm)	B (mm)	R (mm)	Wall Thickness	
						S235JR (mm)	Stainless Steel (mm)
510800000020	2	50	60.3	21	51	2.9	2
510800000025	2.5	65	76.1	26	63	2.9	2
510800000030	3	80	88.9	32	76	3.2	2
510800000040	4	100	114.3	42	102	3.6	2
510800000050	5	125	139.7	53	127	4.0	3
510800000060	6	150	168.3	64	203	4.5	3

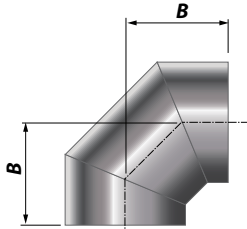

## SEGMENTED ELBOWS SHORT RADIUS TANGENT CUT

Article No.	A Size (Inch)	NB (mm)	Pipe (mm)	B (mm)	Wall Thickness (mm)
51200000080	8	200	219.1	220	3
51200000100	10	250	273.0	275	3
51200000120	12	300	323.9	325	3
51200000140	14	350	355.6	360	3
51200000160	16	400	406.4	410	3
51200000180	18	450	457.2	460	3
51200000200	20	500	508.0	510	3
51200000220	22	550	560.0	560	4
51200000240	24	600	609.6	610	4
51200000260	26	650	664.0	665	4
51200000280	28	700	711.2	715	4
51200000300	30	750	762.0	765	4

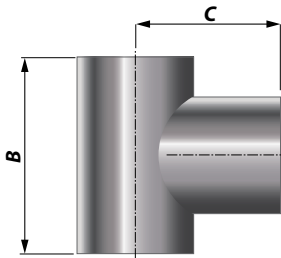

## T-JOINTS

Article No.	A Size (Inch)	NB (mm)	Pipe (mm)	B (mm)	C (mm)	Wall Thickness (mm)
51700000080	8	200	219.1	400	200	3
51700000100	10	250	273.0	500	250	3
51700000120	12	300	323.9	600	300	3
51700000140	14	350	355.6	700	350	3
51700000160	16	400	406.4	800	400	3
51700000180	18	450	457.2	900	450	3
51700000200	20	500	508.0	1000	500	3
51700000220	22	550	560.0	1100	550	4
51700000240	24	600	609.6	1200	600	4
51700000260	26	650	664.0	1300	650	4
51700000280	28	700	711.2	1400	700	4
51700000300	30	750	762.0	1500	750	4

# AXCES EXHAUST PIPING

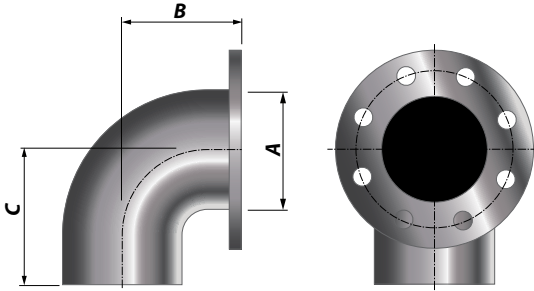

## ELBOWS ONE END FLANGED

Article No.	A Size (Inch)	NB (mm)	Pipe (mm)	B (mm)	C (mm)	Wall Thickness (mm)
510100000040	4	100	114.3	112	190	2
510100000050	5	125	139.7	133	229	3
510100000060	6	150	168.3	159	279	3
510100000080	8	200	219.1	254	310	3
510100000100	10	250	273.0	279	356	3
510100000120	12	300	323.9	310	406	3

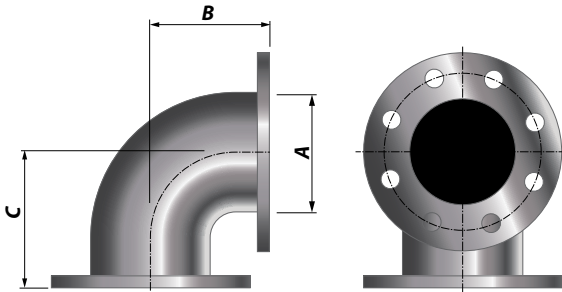

## ELBOWS BOTH ENDS FLANGED

Article No.	A Size (Inch)	NB (mm)	Pipe (mm)	B (mm)	C (mm)	Wall Thickness (mm)
510200000040	4	100	114.3	19	19	2
510200000050	5	125	139.7	23	23	3
510200000060	6	150	168.3	28	28	3
510200000080	8	200	219.1	30	30	3
510200000100	10	250	273.0	36	36	3
510200000120	12	300	323.9	41	41	3

# AXCES EXHAUST PIPING

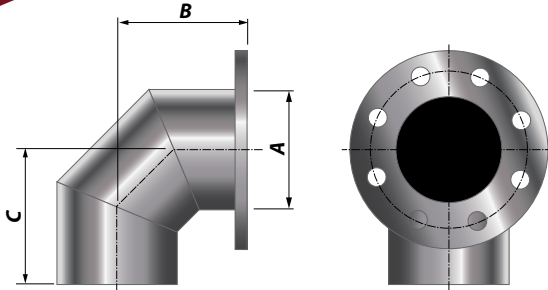

## SEGMENTED ELBOWS ONE END FLANGED

Article No.	A Size (Inch)	NB (mm)	Pipe (mm)	B (mm)	C (mm)	Wall Thickness (mm)
510900000080	8	200	219.1	20	20	3
510900000100	10	250	273.0	25	25	3
510900000120	12	300	323.9	30	30	3
510900000140	14	350	355.6	36	36	3
510900000160	16	400	406.4	41	41	3
510900000180	18	450	457.2	46	46	3
510900000200	20	500	508.0	51	51	3
510900000220	22	550	560.0	56	56	4
510900000240	24	600	609.6	61	61	4
510900000260	26	650	664.0	66	66	4
510900000280	28	700	711.2	71	71	4
510900000300	30	750	762.0	76	76	4

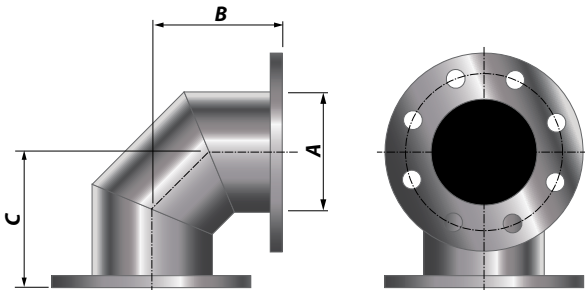

## SEGMENTED ELBOWS BOTH ENDS FLANGED

Article No.	A Size (Inch)	NB (mm)	Pipe (mm)	B (mm)	C (mm)	Wall Thickness (mm)
511000000080	8	200	219.1	20	20	3
511000000100	10	250	273.0	25	25	3
511000000120	12	300	323.9	30	30	3
511000000140	14	350	355.6	36	36	3
511000000160	16	400	406.4	41	41	3
511000000180	18	450	457.2	46	46	3
511000000200	20	500	508.0	51	51	3
511000000220	22	550	560.0	56	56	4
511000000240	24	600	609.6	61	61	4
511000000260	26	650	664.0	66	66	4
511000000280	28	700	711.2	71	71	4
511000000300	30	750	762.0	76	76	4

# AXCES EXHAUST PIPING

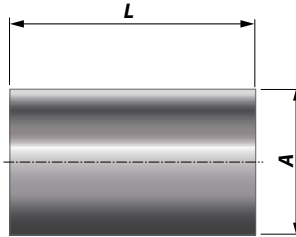

## WELDED TUBES

Article No.	A Size (Inch)	NB (mm)	Pipe (mm)	L (mm)
51300000015	1.5	40	48.3	100 - 8000
51300000020	2	50	60.3	100 - 8000
51300000025	2.5	65	76.1	100 - 8000
51300000030	3	80	88.9	100 - 8000
51300000040	4	100	114.3	100 - 8000
51300000050	5	125	139.7	100 - 8000
51300000060	6	150	168.3	100 - 8000
51300000080	8	200	219.1	100 - 8000
51300000100	10	250	273.0	100 - 8000
51300000120	12	300	323.9	100 - 8000
51300000140	14	350	355.6	100 - 8000
51300000160	16	400	406.4	100 - 8000
51300000180	18	450	457.2	100 - 8000
51300000200	20	500	508.0	100 - 8000
51300000220	22	550	560.0	100 - 8000
51300000240	24	600	609.6	100 - 8000
51300000260	26	650	664.0	100 - 8000
51300000280	28	700	711.2	100 - 8000
51300000300	30	750	762.0	100 - 8000

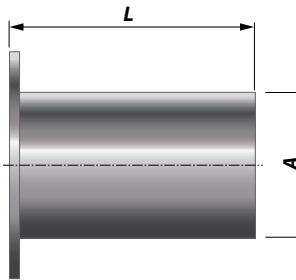

## WELDED TUBES ONE END FLANGED

Article No.	A Size (Inch)	NB (mm)	Pipe (mm)	L (mm)
51400000040	4	100	114.3	100 - 8000
51400000050	5	125	139.7	100 - 8000
51400000060	6	150	168.3	100 - 8000
51400000080	8	200	219.1	100 - 8000
51400000100	10	250	273.0	100 - 8000
51400000120	12	300	323.9	100 - 8000
51400000140	14	350	355.6	100 - 8000
51400000160	16	400	406.4	100 - 8000
51400000180	18	450	457.2	100 - 8000
51400000200	20	500	508.0	100 - 8000
51400000220	22	550	560.0	100 - 8000
51400000240	24	600	609.6	100 - 8000
51400000260	26	650	664.0	100 - 8000
51400000280	28	700	711.2	100 - 8000
51400000300	30	750	762.0	100 - 8000

# AXCES EXHAUST PIPING

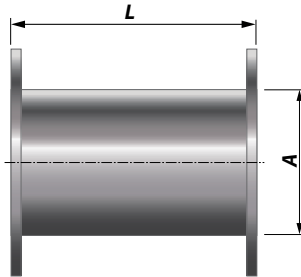

## WELDED TUBES BOTH ENDS FLANGED

Article No.	A Size (Inch)	NB (mm)	Pipe (mm)	L (mm)
515000000040	4	100	114.3	100 - 8000
515000000050	5	125	139.7	100 - 8000
515000000060	6	150	168.3	100 - 8000
515000000080	8	200	219.1	100 - 8000
515000000100	10	250	273.0	100 - 8000
515000000120	12	300	323.9	100 - 8000
515000000140	14	350	355.6	100 - 8000
515000000160	16	400	406.4	100 - 8000
515000000180	18	450	457.2	100 - 8000
515000000200	20	500	508.0	100 - 8000
515000000220	22	550	560.0	100 - 8000
515000000240	24	600	609.6	100 - 8000
515000000260	26	650	664.0	100 - 8000
515000000280	28	700	711.2	100 - 8000
515000000300	30	750	762.0	100 - 8000

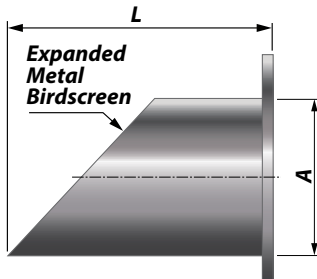

## WELDED TUBES CUT WITH BIRDSCREEN

Article No.	A Size (Inch)	NB (mm)	Pipe (mm)	L (mm)
516000000040	4	100	114.3	100 - 8000
516000000050	5	125	139.7	100 - 8000
516000000060	6	150	168.3	100 - 8000
516000000080	8	200	219.1	100 - 8000
516000000100	10	250	273.0	100 - 8000
516000000120	12	300	323.9	100 - 8000
516000000140	14	350	355.6	100 - 8000
516000000160	16	400	406.4	100 - 8000
516000000180	18	450	457.2	100 - 8000
516000000200	20	500	508.0	100 - 8000
516000000220	22	550	560.0	100 - 8000
516000000240	24	600	609.6	100 - 8000
516000000260	26	650	664.0	100 - 8000
516000000280	28	700	711.2	100 - 8000
516000000300	30	750	762.0	100 - 8000

