

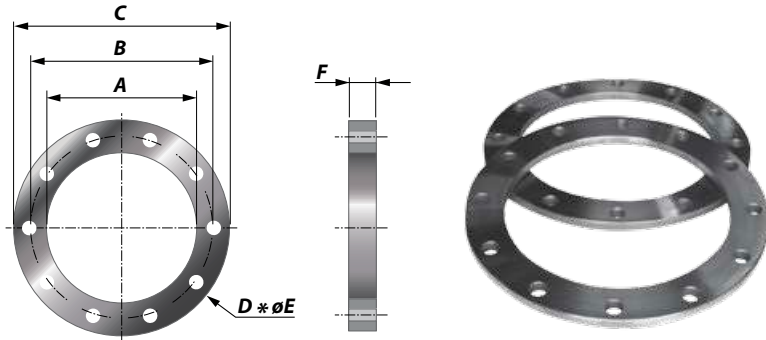

**FLANGES &
GASKETS**



FLANGE TYPE DIN 2573 - PN6



Article No.	Size (Inch)	NB (mm)	Pipe (mm)	A (mm)	B (mm)	C (mm)	D Number of holes	E Diameter of holes (mm)	F (mm)	Weight (kg)
212000120010	1	25	33.4	35	75	100	4	11	12	1
212000120013	1.25	32	42.2	43	90	120	4	14	12	1
212000120015	1.5	40	48.3	49	100	130	4	14	12	1
212000120020	2	50	60.3	61	110	140	4	14	12	2
212000120025	2.5	65	76.1	73	130	160	4	14	12	2
212000120030	3	80	88.9	90	150	190	4	18	12	2
212000120040	4	100	114.3	116	170	210	4	18	12	2
212000160050	5	125	139.7	142	200	240	8	18	16	4
212000160060	6	150	168.3	171	225	265	8	18	16	4
212000160080	8	200	219.1	222	280	320	8	18	16	5
212000160100	10	250	273.0	276	335	375	12	18	16	6
212000160120	12	300	323.9	327	395	440	12	22	16	8
212000160140	14	350	355.6	360	445	490	12	22	16	10
212000160160	16	400	406.4	411	495	540	16	22	16	11
212000160180	18	450	457.2	461	550	595	16	22	16	13
212000200200	20	500	508.0	512	600	645	20	22	16	14
212000200240	24	600	609.6	614	705	755	20	26	20	22
212000200280	28	700	711.2	716	810	860	24	26	20	25
212000200320	32	800	812.8	818	920	975	24	30	20	31
212000200360	36	900	914.4	920	1020	1075	24	30	20	35
212000200400	40	1000	1016.0	1022	1120	1022	28	30	20	38

CHARACTERISTICS

Flanges Hole pattern according type DIN 2573 - PN6

Material Flanges are produced out of Steel S235JRG2

Range Diameter range from 33.4 mm up to 1016 mm

Thickness From minimum 12 mm up to maximum 20 mm

Temperature The maximum allowable temperature is 600°C

FLANGE TYPE DIN 2576 - PN10

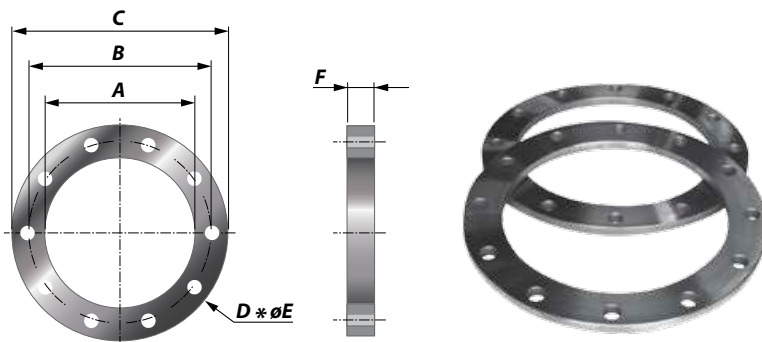

Article No.	Size (Inch)	NB (mm)	Pipe (mm)	A (mm)	B (mm)	C (mm)	D Number of holes	E Diameter of holes (mm)	F (mm)	Weight (kg)
212010120010	1	25	33.4	35	85	115	4	14	12	1
212010120013	1.25	32	42.2	43	100	140	4	18	12	1
212010120015	1.5	40	48.3	49	110	150	4	18	12	1
212010120020	2	50	60.3	61	125	165	4	18	12	2
212010120025	2.5	65	76.1	73	145	185	4	18	12	2
212010120030	3	80	88.9	90	160	200	4	18	12	2
212010120040	4	100	114.3	116	180	220	4	18	12	2
212010160050	5	125	139.7	142	210	250	8	18	16	4
212010160060	6	150	168.3	171	240	285	8	22	16	4
212010160080	8	200	219.1	222	295	340	8	22	16	5
212010160100	10	250	273.0	276	350	395	12	22	16	6
212010160120	12	300	323.9	327	400	445	12	22	16	8
212010200140	14	350	355.6	360	460	505	12	22	16	10
212010200160	16	400	406.4	411	515	565	16	26	16	11
212010200180	18	450	457.2	461	565	615	16	26	16	13
212010200200	20	500	508.0	512	620	670	20	26	16	14
212010200240	24	600	609.6	614	725	780	20	30	20	22
212010200280	28	700	711.2	716	840	895	24	30	20	25
212010200320	32	800	812.8	818	950	1015	24	33	20	31
212010200360	36	900	914.4	920	1050	1115	24	33	20	35
212010200400	40	1000	1016.0	1022	1160	1230	28	36	20	38

CHARACTERISTICS

Flanges Hole pattern according type DIN 2576 - PN10

Material Flanges are produced out of Steel S235JRG2

Range Diameter range from 33.4 mm up to 1016 mm

Thickness From minimum 12 mm up to maximum 20 mm

Temperature The maximum allowable temperature is 600°C

FLANGE TYPE DIN 86044

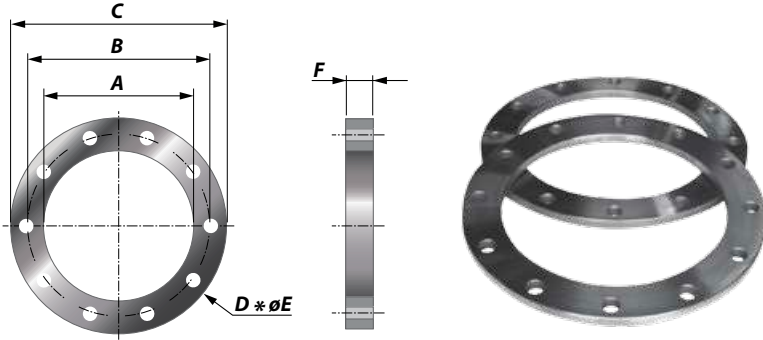

Article No.	Size (Inch)	NB (mm)	Pipe (mm)	A (mm)	B (mm)	C (mm)	D Number of holes	E Diameter of holes (mm)	F (mm)	Weight (kg)
212020160100	10	250	273.0	276	335	375	12	18	16	6
212020160120	12	300	323.9	327	395	440	12	22	16	8
212020160140	14	350	355.6	360	445	490	12	22	16	10
212020160160	16	400	406.4	411	495	540	16	22	16	11
212020160180	18	450	457.2	461	550	595	16	22	16	13
212020160200	20	500	508.0	512	600	645	20	22	16	14
212020200220	22	550	560.0	563	650	703	20	22	20	20
212020200240	24	600	609.6	614	700	754	20	22	20	22
212020200260	26	650	664.0	665	750	805	20	22	20	24
212020200280	28	700	711.2	716	800	856	24	22	20	25
212020200300	30	750	762.0	767	860	907	24	22	20	27
212020200320	32	800	812.8	818	900	958	24	22	20	29
212020200360	36	900	914.4	920	1010	1060	28	22	20	32
212020200380	38	950	698.0	970	1060	1110	28	22	20	34
212020200400	40	1000	1016.0	1022	1110	1167	32	22	20	36
212020200440	44	1100	1120.0	1126	1210	1266	32	22	20	39
212020200480	48	1200	1220.0	1226	1310	1366	36	22	20	42
212020200520	52	1300	1324.0	1326	1410	1466	40	22	20	45

CHARACTERISTICS

Flanges Hole pattern according type DIN 86044

Material Flanges are produced out of Steel S235JRG2

Range Diameter range from 273 mm up to 1324 mm

Thickness From minimum 16 mm up to maximum 20 mm

Temperature The maximum allowable temperature is 600°C

FLANGE TYPE ANSI 150

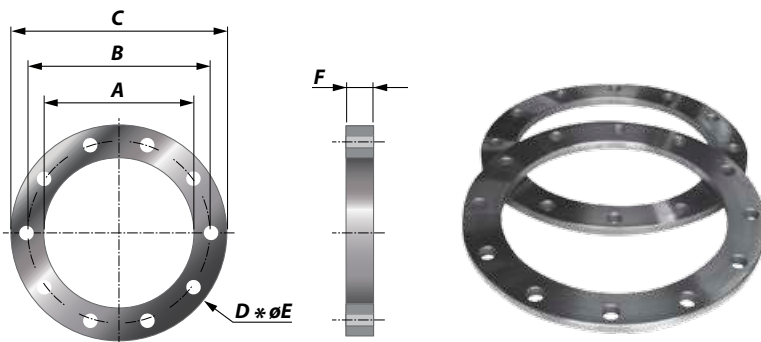

Article No.	Size (Inch)	NB (mm)	Pipe (mm)	A (mm)	B (mm)	C (mm)	D Number of holes	E Diameter of holes (mm)	F (mm)	Weight (kg)
212030150010	1	25	33.4	35	79	110	4	16	15	1
212030160013	1.25	32	42.2	43	89	120	4	16	16	1
212030180015	1.5	40	48.3	49	99	130	4	16	18	1
212030200020	2	50	60.3	61	121	150	4	19	20	2
212030230025	2.5	65	76.1	73	140	180	4	19	23	4
212030240030	3	80	88.9	90	153	190	4	19	24	4
212030240040	4	100	114.3	116	191	230	8	19	24	6
212030240050	5	125	139.7	142	216	255	8	22	24	6
212030260060	6	150	168.3	171	242	280	8	22	26	8
212030290080	8	200	219.1	222	299	345	8	22	29	13
212030310100	10	250	273.0	276	362	405	12	26	31	17
212030320120	12	300	323.9	327	432	485	12	26	32	27
212030350140	14	350	355.6	360	476	535	12	30	35	35
212030370160	16	400	406.4	411	540	600	16	30	37	42
212030400180	18	450	457.2	461	578	635	16	33	40	53
212030430200	20	500	508.0	512	635	700	20	33	43	65
212030480240	24	600	609.6	614	750	815	20	36	48	92

CHARACTERISTICS

Flanges Hole pattern according type ANSI 150 Standard

Material Flanges are produced out of Steel S235JRG2

Range Diameter range from 33.4 mm up to 609.6 mm

Thickness From minimum 15 mm up to maximum 48 mm

Temperature The maximum allowable temperature is 600°C

FLANGE TYPE JIS B2220 - 5K

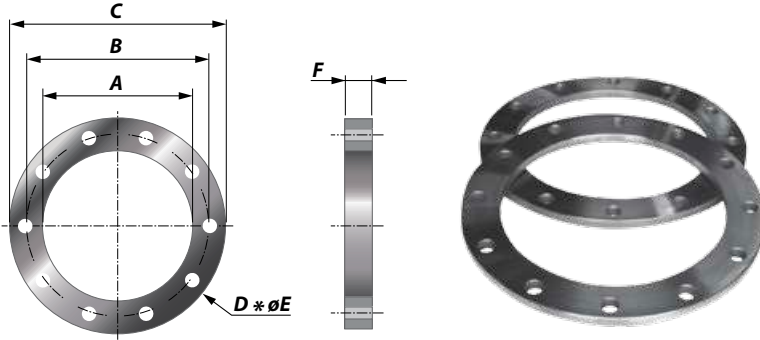

Article No.	Size (Inch)	NB (mm)	Pipe (mm)	A (mm)	B (mm)	C (mm)	D Number of holes	E Diameter of holes (mm)	F (mm)	Weight (kg)
212040100010	1	25	33.4	35	75	95	4	12	10	1
212040100013	1.25	32	42.2	43	90	115	4	15	12	1
212040100015	1.5	40	48.3	49	95	120	4	15	12	1
212040140020	2	50	60.3	61	105	130	4	15	14	1
212040140025	2.5	65	76.1	77	130	155	4	15	14	2
212040140030	3	80	88.9	90	145	180	4	19	14	2
212040160040	4	100	114.3	116	165	200	8	19	16	2
212040160050	5	125	139.7	142	200	235	8	19	16	3
212040180060	6	150	168.3	167	230	265	8	19	18	4
212040200080	8	200	219.1	218	280	320	8	23	20	6
212040220100	10	250	273.0	270	345	385	12	23	22	9
212040220120	12	300	323.9	321	390	430	12	23	22	10
212040240140	14	350	355.6	358	435	480	12	25	24	14
212040240160	16	400	406.4	409	495	540	16	25	24	17
212040240180	18	450	457.2	460	555	605	16	25	24	22
212040240200	20	500	508.0	511	605	655	20	25	24	23
212040260240	24	600	609.6	613	715	770	20	27	26	32
212040260280	28	700	711.2	715	820	875	24	27	26	38
212040280320	32	800	812.8	817	930	995	24	33	28	52
212040300360	36	900	914.4	919	1030	1095	24	33	30	61
212040320400	40	1000	1016.0	1021	1130	1195	28	33	32	71

CHARACTERISTICS

- Flanges** Hole pattern according type JIS Standard
- Material** Flanges are produced out of Steel S235JRG2
- Range** Diameter range from 33.4 mm up to 1016 mm
- Thickness** From minimum 10 mm up to maximum 32 mm
- Temperature** The maximum allowable temperature is 600°C

FLANGE TYPE JIS B2220 - 10K

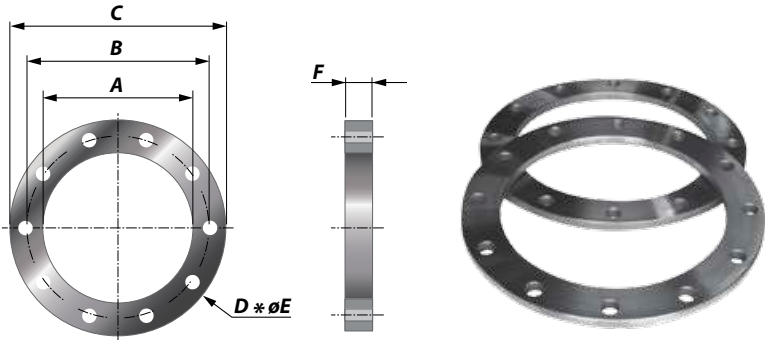

Article No.	Size (Inch)	NB (mm)	Pipe (mm)	A (mm)	B (mm)	C (mm)	D Number of holes	E Diameter of holes (mm)	F (mm)	Weight (kg)
212050140010	1	25	34.5	35	90	125	4	19	14	1
212050160013	1.25	32	43.2	43	100	135	4	19	16	2
212050160015	1.5	40	49.1	49	105	140	4	19	16	2
212050160020	2	50	61.1	61	120	155	4	19	16	2
212050180025	2.5	65	77.1	77	140	175	4	19	18	3
212050180030	3	80	90.0	90	150	185	8	19	18	3
212050180040	4	100	115.4	116	175	210	8	19	18	3
212050200050	5	125	141.2	142	210	250	8	23	20	5
212050220060	6	150	166.6	167	240	280	8	23	22	6
212050220080	8	200	218.0	218	290	330	12	23	22	8
212050240100	10	250	269.5	270	355	400	12	25	24	12
212050240120	12	300	321.0	321	400	445	16	25	24	14
212050260140	14	350	358.1	358	445	490	16	25	26	16
212050280160	16	400	409.0	409	510	560	16	27	28	23
212050300180	18	450	460.0	460	565	620	20	27	30	30
212050300200	20	500	511.0	511	620	675	20	27	30	34
212050320240	24	600	613.0	613	730	795	24	33	32	46
212050340280	28	700	715.0	715	840	905	24	33	34	60
212050360320	32	800	817.0	817	950	1020	28	33	36	76
212050380360	36	900	919.0	919	1050	1120	28	33	38	89
212050400400	40	1000	1021.0	1021	1160	1235	28	39	40	109

CHARACTERISTICS

Flanges Hole pattern according type JIS Standard

Material Flanges are produced out of Steel S235JRG2

Range Diameter range from 34.5 mm up to 1021 mm

Thickness From minimum 14 mm up to maximum 40 mm

Temperature The maximum allowable temperature is 600°C

BLIND FLANGE TYPE DIN 2573 - PN6

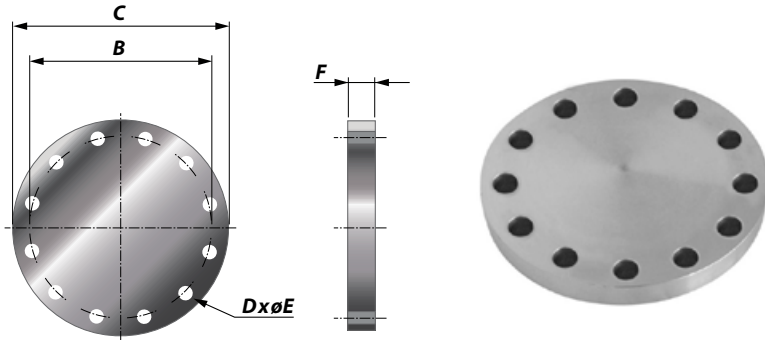

Article No.	Size (Inch)	NB (mm)	Pipe (mm)	B (mm)	C (mm)	D Number of holes	E Diameter of holes (mm)	F (mm)	Weight (kg)
212000120010	1	25	33.4	75	100	4	11	12	1
212000120013	1.25	32	42.2	90	120	4	14	12	1
212000120015	1.5	40	48.3	100	130	4	14	12	1
212000120020	2	50	60.3	110	140	4	14	12	1
212000120025	2.5	65	76.1	130	160	4	14	12	2
212000120030	3	80	88.9	150	190	4	18	12	3
212000120040	4	100	114.3	170	210	4	18	12	3
212000160050	5	125	139.7	200	240	8	18	16	6
212000160060	6	150	168.3	225	265	8	18	16	7
212000160080	8	200	219.1	280	320	8	18	16	10
212000160100	10	250	273.0	335	375	12	18	16	14
212000160120	12	300	323.9	395	440	12	22	16	19
212000160140	14	350	355.6	445	490	12	22	16	24
212000160160	16	400	406.4	495	540	16	22	16	29
212000160180	18	450	457.2	550	595	16	22	16	36
212000200200	20	500	508.0	600	645	20	22	16	42
212000200240	24	600	609.6	705	755	20	26	20	72
212000200280	28	700	711.2	810	860	24	26	20	93
212000200320	32	800	812.8	920	975	24	30	20	119
212000200360	36	900	914.4	1020	1075	24	30	20	145
212000200400	40	1000	1016.0	1120	1022	28	30	20	173

CHARACTERISTICS

Flanges Hole pattern according type DIN2573 - PN6 Standard

Material Flanges are produced out of Steel S235JRG2

Range Diameter range from 34.4 mm up to 1016 mm

Thickness From minimum 14 mm up to maximum 40 mm

Temperature The maximum allowable temperature is 600°C

BLIND FLANGE TYPE DIN 2576 - PN10

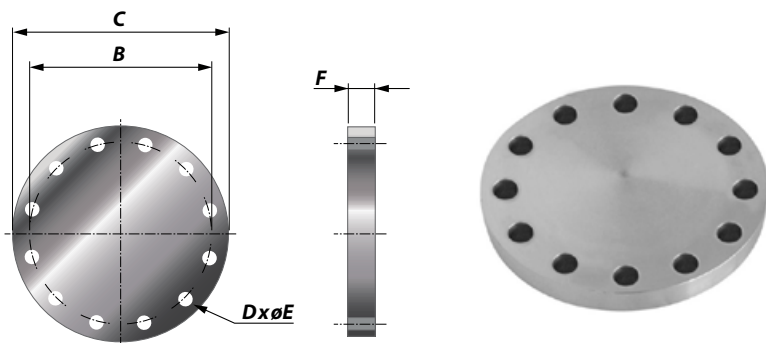

Article No.	Size (Inch)	NB (mm)	Pipe (mm)	B (mm)	C (mm)	D Number of holes	E Diameter of holes (mm)	F (mm)	Weight (kg)
212010120010	1	25	33.4	85	115	4	14	12	1
212010120013	1.25	32	42.2	100	140	4	18	12	1
212010120015	1.5	40	48.3	110	150	4	18	12	1
212010120020	2	50	60.3	125	165	4	18	12	1
212010120025	2.5	65	76.1	145	185	4	18	12	2
212010120030	3	80	88.9	160	200	4	18	12	3
212010120040	4	100	114.3	180	220	4	18	12	3
212010160050	5	125	139.7	210	250	8	18	16	6
212010160060	6	150	168.3	240	285	8	22	16	7
212010160080	8	200	219.1	295	340	8	22	16	10
212010160100	10	250	273.0	350	395	12	22	16	14
212010160120	12	300	323.9	400	445	12	22	16	19
212010200140	14	350	355.6	460	505	12	22	16	24
212010200160	16	400	406.4	515	565	16	26	16	29
212010200180	18	450	457.2	565	615	16	26	16	36
212010200200	20	500	508.0	620	670	20	26	16	42
212010200240	24	600	609.6	725	780	20	30	20	72
212010200280	28	700	711.2	840	895	24	30	20	93
212010200320	32	800	812.8	950	1015	24	33	20	119
212010200360	36	900	914.4	1050	1115	24	33	20	145
212010200400	40	1000	1016.0	1160	1230	28	36	20	173

CHARACTERISTICS

Flanges Hole pattern according type DIN2573 - PN10 Standard

Material Flanges are produced out of Steel S235JRG2

Range Diameter range from 34.4 mm up to 1016 mm

Thickness From minimum 14 mm up to maximum 40 mm

Temperature The maximum allowable temperature is 600°C

GRAPHITE GASKET TYPE FULL FACE DIN 2573 - PN6

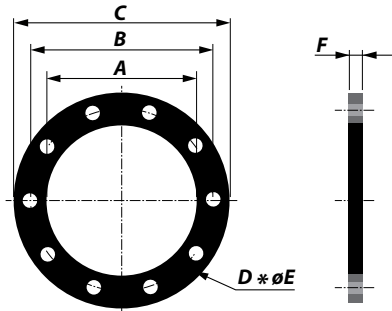

Article No.	Size (Inch)	NB (mm)	Pipe (mm)	A (mm)	B (mm)	C (mm)	D Number of holes	E Diameter of holes (mm)	F (mm)	Weight (kg)
213100020010	1	25	33.4	35	75	100	4	11	2	0.1
213100020013	1.25	32	42.2	43	90	120	4	14	2	0.1
213100020015	1.5	40	48.3	49	100	130	4	14	2	0.1
213100020020	2	50	60.3	61	110	140	4	14	2	0.1
213100020025	2.5	65	76.1	73	130	160	4	14	2	0.2
213100020030	3	80	88.9	90	150	190	4	18	2	0.2
213100020040	4	100	114.3	116	170	210	4	18	2	0.2
213100020050	5	125	139.7	142	200	240	8	18	2	0.2
213100020060	6	150	168.3	171	225	265	8	18	2	0.3
213100020080	8	200	219.1	222	280	320	8	18	2	0.3
213100020100	10	250	273.0	276	335	375	12	18	2	0.3
213100020120	12	300	323.9	327	395	440	12	22	2	0.3
213100020140	14	350	355.6	360	445	490	12	22	2	0.4
213100020160	16	400	406.4	411	495	540	16	22	2	0.4
213100020180	18	450	457.2	461	550	595	16	22	2	0.4
213100020200	20	500	508.0	512	600	645	20	22	2	0.5
213100020240	24	600	609.6	614	705	755	20	26	2	0.8
213100020280	28	700	711.2	716	810	860	24	26	2	0.8
213100020320	32	800	812.8	818	920	975	24	30	2	0.8
213100020360	36	900	914.4	920	1020	1075	24	30	2	1
213100020400	40	1000	1016.0	1022	1120	1022	28	30	2	1

CHARACTERISTICS

Gaskets Hole pattern according type DIN 2573 - PN6

Material Gaskets are produced out of graphite

Range Diameter range from 33.4 mm up to 1016 mm

Thickness 2 mm, with an option for 3 and 4 mm

Temperature The maximum allowable temperature is 600°C

GRAPHITE GASKET TYPE FULL FACE DIN 2576 - PN10

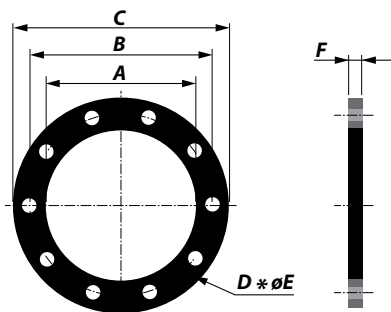

Article No.	Size (Inch)	NB (mm)	Pipe (mm)	A (mm)	B (mm)	C (mm)	D Number of holes	E Diameter of holes (mm)	F (mm)	Weight (kg)
213110020010	1	25	33.4	35	85	115	4	14	2	0.1
213110020013	1.25	32	42.2	43	100	140	4	18	2	0.1
213110020015	1.5	40	48.3	49	110	150	4	18	2	0.1
213110020020	2	50	60.3	61	125	165	4	18	2	0.1
213110020025	2.5	65	76.1	73	145	185	4	18	2	0.2
213110020030	3	80	88.9	90	160	200	4	18	2	0.2
213110020040	4	100	114.3	116	180	220	4	18	2	0.2
213110020050	5	125	139.7	142	210	250	8	18	2	0.2
213110020060	6	150	168.3	171	240	285	8	22	2	0.3
213110020080	8	200	219.1	222	295	340	8	22	2	0.3
213110020100	10	250	273.0	276	350	395	12	22	2	0.3
213110020120	12	300	323.9	327	400	445	12	22	2	0.3
213110020140	14	350	355.6	360	460	505	12	22	2	0.4
213110020160	16	400	406.4	411	515	565	16	26	2	0.4
213110020180	18	450	457.2	461	565	615	16	26	2	0.4
213110020200	20	500	508.0	512	620	670	20	26	2	0.5
213110020240	24	600	609.6	614	725	780	20	30	2	0.8
213110020280	28	700	711.2	716	840	895	24	30	2	0.8
213110020320	32	800	812.8	818	950	1015	24	33	2	0.8
213110020360	36	900	914.4	920	1050	1115	24	33	2	1
213110020400	40	1000	1016.0	1022	1160	1230	28	36	2	1

CHARACTERISTICS

Gaskets Hole pattern according type DIN 2576 - PN10

Material Gaskets are produced out of graphite

Range Diameter range from 33.4 mm up to 1016 mm

Thickness 2 mm, with an option for 3 and 4 mm

Temperature The maximum allowable temperature is 600°C

GRAPHITE GASKET TYPE FULL FACE DIN 86044

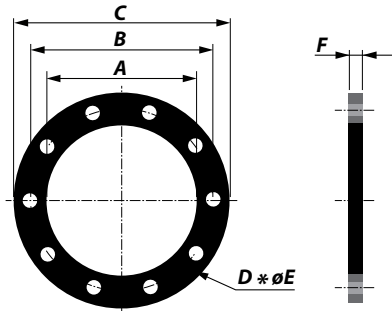

Article No.	Size (Inch)	NB (mm)	Pipe (mm)	A (mm)	B (mm)	C (mm)	D Number of holes	E Diameter of holes (mm)	F (mm)	Weight (kg)
213120020100	10	250	273.0	276	335	375	12	18	2	0.3
213120020120	12	300	323.9	327	395	440	12	22	2	0.3
213120020140	14	350	355.6	360	445	490	12	22	2	0.4
213120020160	16	400	406.4	411	495	540	16	22	2	0.4
213120020180	18	450	457.2	461	550	595	16	22	2	0.4
213120020200	20	500	508.0	512	600	645	20	22	2	0.5
213120020220	22	550	560.0	563	650	703	20	22	2	0.5
213120020240	24	600	609.6	614	700	754	20	22	2	0.8
213120020260	26	650	664.0	665	750	805	20	22	2	0.8
213120020280	28	700	711.2	716	800	856	24	22	2	0.8
213120020300	30	750	762.0	767	860	907	24	22	2	0.8
213120020320	32	800	812.8	818	900	958	24	22	2	0.8
213120020360	36	900	914.4	920	1010	1060	28	22	2	1
213120020380	38	950	998.0	970	1060	1110	28	22	2	1
213120020400	40	1000	1016.0	1022	1110	1167	32	22	2	1
213120020440	44	1100	1120.0	1126	1210	1266	32	22	2	1
213120020480	48	1200	1220.0	1226	1310	1366	36	22	2	1
213120020520	52	1300	1324.0	1326	1410	1466	40	22	2	1

CHARACTERISTICS

Gaskets Hole pattern according type DIN 86044

Material Gaskets are produced out of graphite

Range Diameter range from 273 mm up to 1324 mm

Thickness 2 mm, with an option for 3 and 4 mm

Temperature The maximum allowable temperature is 600°C

GRAPHITE GASKET TYPE FULL FACE ANSI 150

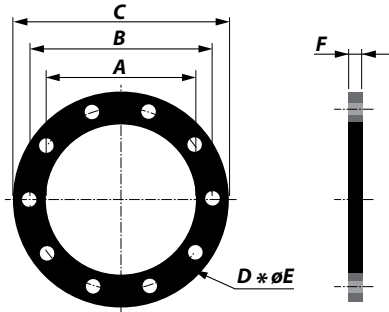

Article No.	Size (Inch)	NB (mm)	Pipe (mm)	A (mm)	B (mm)	C (mm)	D Number of holes	E Diameter of holes (mm)	F (mm)	Weight (kg)
213130020010	1	25	33.4	35	79	110	4	16	2	0.1
213130020013	1.25	32	42.2	43	89	120	4	16	2	0.1
213130020015	1.5	40	48.3	49	99	130	4	16	2	0.1
213130020020	2	50	60.3	61	121	150	4	19	2	0.1
213130020025	2.5	65	76.1	73	140	180	4	19	2	0.2
213130020030	3	80	88.9	90	153	190	4	19	2	0.2
213130020040	4	100	114.3	116	191	230	8	19	2	0.2
213130020050	5	125	139.7	142	216	255	8	22	2	0.2
213130020060	6	150	168.3	171	242	280	8	22	2	0.3
213130020080	8	200	219.1	222	299	345	8	22	2	0.3
213130020100	10	250	273.0	276	362	405	12	26	2	0.3
213130020120	12	300	323.9	327	432	485	12	26	2	0.3
213130020140	14	350	355.6	360	476	535	12	30	2	0.4
213130020160	16	400	406.4	411	540	600	16	30	2	0.4
213130020180	18	450	457.2	461	578	635	16	33	2	0.4
213130020200	20	500	508.0	512	635	700	20	33	2	0.5
213130020240	24	600	609.6	614	750	815	20	36	2	0.8

CHARACTERISTICS

Gaskets Hole pattern according type ANSI 150 Standard

Material Gaskets are produced out of graphite

Range Diameter range from 33.4 mm up to 609.6 mm

Thickness 2 mm, with an option for 3 and 4 mm

Temperature The maximum allowable temperature is 600°C

GRAPHITE GASKET TYPE FULL FACE JIS B2220 - 5K

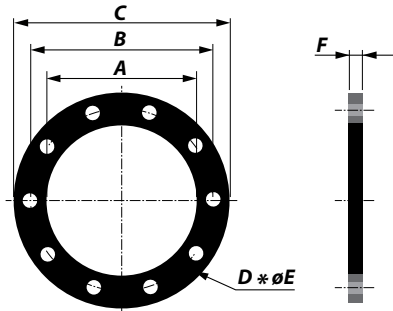

Article No.	Size (Inch)	NB (mm)	Pipe (mm)	A (mm)	B (mm)	C (mm)	D Number of holes	E Diameter of holes (mm)	F (mm)	Weight (kg)
213140020010	1	25	33.4	35	75	95	4	12	2	0.1
213140020013	1.25	32	42.2	43	90	115	4	15	2	0.1
213140020015	1.5	40	48.3	49	95	120	4	15	2	0.1
213140020020	2	50	60.3	61	105	130	4	15	2	0.1
213140020025	2.5	65	76.1	77	130	155	4	15	2	0.2
213140020030	3	80	88.9	90	145	180	4	19	2	0.2
213140020040	4	100	114.3	116	165	200	8	19	2	0.2
213140020050	5	125	139.7	142	200	235	8	19	2	0.2
213140020060	6	150	168.3	167	230	265	8	19	2	0.3
213140020080	8	200	219.1	218	280	320	8	23	2	0.3
213140020100	10	250	273.0	270	345	385	12	23	2	0.3
213140020120	12	300	323.9	321	390	430	12	23	2	0.3
213140020140	14	350	355.6	358	435	480	12	25	2	0.4
213140020160	16	400	406.4	409	495	540	16	25	2	0.4
213140020180	18	450	457.2	460	555	605	16	25	2	0.4
213140020200	20	500	508.0	511	605	655	20	25	2	0.5
213140020240	24	600	609.6	613	715	770	20	27	2	0.8
213140020280	28	700	711.2	715	820	875	24	27	2	0.8
213140020320	32	800	812.8	817	930	995	24	33	2	0.8
213140020360	36	900	914.4	919	1030	1095	24	33	2	1
213140020400	40	1000	1016.0	1021	1130	1195	28	33	2	1

CHARACTERISTICS

Gaskets Hole pattern according type JIS Standard

Material Gaskets are produced out of graphite

Range Diameter range from 33.4 mm up to 1016 mm

Thickness 2 mm, with an option for 3 and 4 mm

Temperature The maximum allowable temperature is 600°C

GRAPHITE GASKET TYPE FULL FACE JIS B2220 - 10K

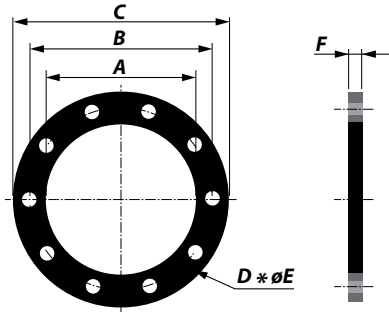

Article No.	Size (Inch)	NB (mm)	Pipe (mm)	A (mm)	B (mm)	C (mm)	D Number of holes	E Diameter of holes (mm)	F (mm)	Weight (kg)
213150020010	1	25	34.5	35	90	125	4	19	2	0.1
213150020013	1.25	32	43.2	43	100	135	4	19	2	0.1
213150020015	1.5	40	49.1	49	105	140	4	19	2	0.1
213150020020	2	50	61.1	61	120	155	4	19	2	0.1
213150020025	2.5	65	77.1	77	140	175	4	19	2	0.2
213150020030	3	80	90.0	90	150	185	8	19	2	0.2
213150020040	4	100	115.4	116	175	210	8	19	2	0.2
213150020050	5	125	141.2	142	210	250	8	23	2	0.2
213150020060	6	150	166.6	167	240	280	8	23	2	0.3
213150020080	8	200	218.0	218	290	330	12	23	2	0.3
213150020100	10	250	269.5	270	355	400	12	25	2	0.3
213150020120	12	300	321.0	321	400	445	16	25	2	0.3
213150020140	14	350	358.1	358	445	490	16	25	2	0.4
213150020160	16	400	409.0	409	510	560	16	27	2	0.4
213150020180	18	450	460.0	460	565	620	20	27	2	0.4
213150020200	20	500	511.0	511	620	675	20	27	2	0.5
213150020240	24	600	613.0	613	730	795	24	33	2	0.8
213150020280	28	700	715.0	715	840	905	24	33	2	0.8
213150020320	32	800	817.0	817	950	1020	28	33	2	0.8
213150020360	36	900	919.0	919	1050	1120	28	33	2	1
213150020400	40	1000	1021.0	1021	1160	1235	28	39	2	1

CHARACTERISTICS

Gaskets Hole pattern according type JIS Standard

Material Gaskets are produced out of graphite

Range Diameter range from 34.5 mm up to 1021 mm

Thickness 2 mm, with an option for 3 and 4 mm

Temperature The maximum allowable temperature is 600°C

GRAPHITE GASKET TYPE CIRCULAR DIN 2573 - PN6

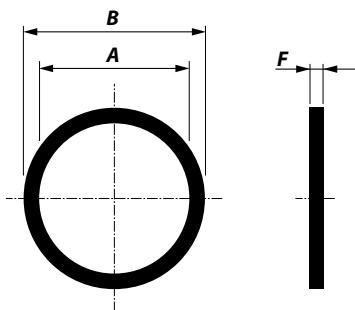

Article No.	Size (Inch)	NB (mm)	Pipe (mm)	A (mm)	B (mm)	F (mm)	Weight (kg)
213300030010	1	25	33.4	35	75	2	0.1
213300030013	1.25	32	42.2	43	90	2	0.1
213300030015	1.5	40	48.3	49	100	2	0.1
213300030020	2	50	60.3	61	110	2	0.1
213300030025	2.5	65	76.1	73	130	2	0.2
213300030030	3	80	88.9	90	150	2	0.2
213300030040	4	100	114.3	116	170	2	0.2
213300030050	5	125	139.7	142	200	2	0.2
213300030060	6	150	168.3	171	225	2	0.3
213300030080	8	200	219.1	222	280	2	0.3
213300030100	10	250	273.0	276	335	2	0.3
213300030120	12	300	323.9	327	395	2	0.3
213300030140	14	350	355.6	360	445	2	0.4
213300030160	16	400	406.4	411	495	2	0.4
213300030180	18	450	457.2	461	550	2	0.4
213300030200	20	500	508.0	512	600	2	0.5
213300030240	24	600	609.6	614	705	2	0.8
213300030280	28	700	711.2	716	810	2	0.8
213300030320	32	800	812.8	818	920	2	0.8
213300030360	36	900	914.4	920	1020	2	1
213300030400	40	1000	1016.0	1022	1120	2	1

CHARACTERISTICS

Material Gaskets are produced out of graphite

Range Diameter range from 33.4 mm up to 1016 mm

Thickness 2 mm, with an option for 3 and 4 mm

Temperature The maximum allowable temperature is 600°C

GRAPHITE GASKET TYPE CIRCULAR DIN 2576 - PN10

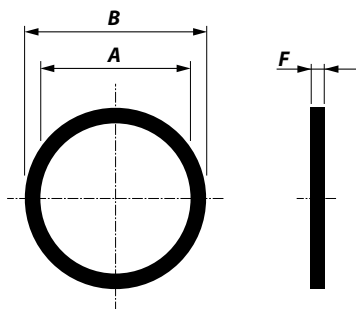

Article No.	Size (Inch)	NB (mm)	Pipe (mm)	A (mm)	B (mm)	F (mm)	Weight (kg)
213310030010	1	25	33.4	35	85	2	0.1
213310030013	1.25	32	42.2	43	100	2	0.1
213310030015	1.5	40	48.3	49	110	2	0.1
213310030020	2	50	60.3	61	125	2	0.1
213310030025	2.5	65	76.1	73	145	2	0.2
213310030030	3	80	88.9	90	160	2	0.2
213310030040	4	100	114.3	116	180	2	0.2
213310030050	5	125	139.7	142	210	2	0.2
213310030060	6	150	168.3	171	240	2	0.3
213310030080	8	200	219.1	222	295	2	0.3
213310030100	10	250	273.0	276	350	2	0.3
213310030120	12	300	323.9	327	400	2	0.3
213310030140	14	350	355.6	360	460	2	0.4
213310030160	16	400	406.4	411	515	2	0.4
213310030180	18	450	457.2	461	565	2	0.4
213310030200	20	500	508.0	512	620	2	0.5
213310030240	24	600	609.6	614	725	2	0.8
213310030280	28	700	711.2	716	840	2	0.8
213310030320	32	800	812.8	818	950	2	0.8
213310030360	36	900	914.4	920	1050	2	1
213310030400	40	1000	1016.0	1022	1160	2	1

CHARACTERISTICS

Material Gaskets are produced out of graphite

Range Diameter range from 33.4 mm up to 1016 mm

Thickness 2 mm, with an option for 3 and 4 mm

Temperature The maximum allowable temperature is 600°C

GRAPHITE GASKET TYPE CIRCULAR DIN 86044

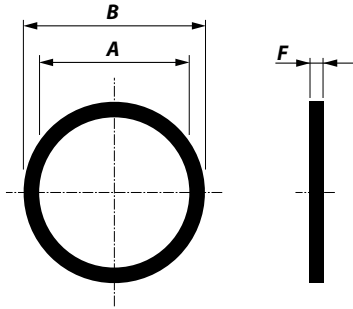

Article No.	Size (Inch)	NB (mm)	Pipe (mm)	A (mm)	B (mm)	F (mm)	Weight (kg)
213320030100	10	250	273.0	276	335	2	0.3
213320030120	12	300	323.9	327	395	2	0.3
213320030140	14	350	355.6	360	445	2	0.4
213320030160	16	400	406.4	411	495	2	0.4
213320030180	18	450	457.2	461	550	2	0.4
213320030200	20	500	508.0	512	600	2	0.5
213320030220	22	550	560.0	563	650	2	0.5
213320030240	24	600	609.6	614	700	2	0.8
213320030260	26	650	664.0	665	750	2	0.8
213320030280	28	700	711.2	716	800	2	0.8
213320030300	30	750	762.0	767	860	2	0.8
213320030320	32	800	812.8	818	900	2	0.8
213320030360	36	900	914.4	920	1010	2	1
213320030380	38	950	698.0	970	1060	2	1
213320030400	40	1000	1016.0	1022	1110	2	1
213320030440	44	1100	1120.0	1126	1210	2	1
213320030480	48	1200	1220.0	1226	1310	2	1
213320030520	52	1300	1324.0	1326	1410	2	1

CHARACTERISTICS

Material Gaskets are produced out of graphite

Range Diameter range from 273 mm up to 1324 mm

Thickness 2 mm, with an option for 3 and 4 mm

Temperature The maximum allowable temperature is 600°C

GRAPHITE GASKET TYPE CIRCULAR ANSI 150

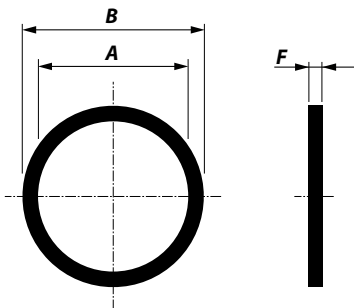

Article No.	Size (Inch)	NB (mm)	Pipe (mm)	A (mm)	B (mm)	F (mm)	Weight (kg)
213330030010	1	25	33.4	35	79	2	0.1
213330030013	1.25	32	42.2	43	89	2	0.1
213330030015	1.5	40	48.3	49	99	2	0.1
213330030020	2	50	60.3	61	121	2	0.1
213330030025	2.5	65	76.1	73	140	2	0.2
213330030030	3	80	88.9	90	153	2	0.2
213330030040	4	100	114.3	116	191	2	0.2
213330030050	5	125	139.7	142	216	2	0.2
213330030060	6	150	168.3	171	242	2	0.3
213330030080	8	200	219.1	222	299	2	0.3
213330030100	10	250	273.0	276	362	2	0.3
213330030120	12	300	323.9	327	432	2	0.3
213330030140	14	350	355.6	360	476	2	0.4
213330030160	16	400	406.4	411	540	2	0.4
213330030180	18	450	457.2	461	578	2	0.4
213330030200	20	500	508.0	512	635	2	0.5
213330030240	24	600	609.6	614	750	2	0.8

CHARACTERISTICS

Material Gaskets are produced out of graphite

Range Diameter range from 33.4 mm up to 609.6 mm

Thickness 2 mm, with an option for 3 and 4 mm

Temperature The maximum allowable temperature is 600°C

GRAPHITE GASKET TYPE CIRCULAR JIS B2220 - 5K

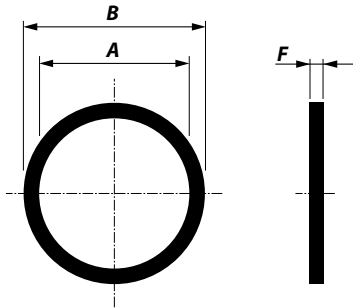

Article No.	Size (Inch)	NB (mm)	Pipe (mm)	A (mm)	B (mm)	F (mm)	Weight (kg)
213340030010	1	25	33.4	35	75	2	0.1
213340030013	1.25	32	42.2	43	90	2	0.1
213340030015	1.5	40	48.3	49	95	2	0.1
213340030020	2	50	60.3	61	105	2	0.1
213340030025	2.5	65	76.1	77	130	2	0.2
213340030030	3	80	88.9	90	145	2	0.2
213340030040	4	100	114.3	116	165	2	0.2
213340030050	5	125	139.7	142	200	2	0.2
213340030060	6	150	168.3	167	230	2	0.3
213340030080	8	200	219.1	218	280	2	0.3
213340030100	10	250	273.0	270	345	2	0.3
213340030120	12	300	323.9	321	390	2	0.3
213340030140	14	350	355.6	358	435	2	0.4
213340030160	16	400	406.4	409	495	2	0.4
213340030180	18	450	457.2	460	555	2	0.4
213340030200	20	500	508.0	511	605	2	0.5
213340030240	24	600	609.6	613	715	2	0.8
213340030280	28	700	711.2	715	820	2	0.8
213340030320	32	800	812.8	817	930	2	0.8
213340030360	36	900	914.4	919	1030	2	1
213340030400	40	1000	1016.0	1021	1130	2	1

CHARACTERISTICS

Material Gaskets are produced out of graphite

Range Diameter range from 33.4 mm up to 1016 mm

Thickness 2 mm, with an option for 3 and 4 mm

Temperature The maximum allowable temperature is 600°C

GRAPHITE GASKET TYPE CIRCULAR JIS B2220 - 10K

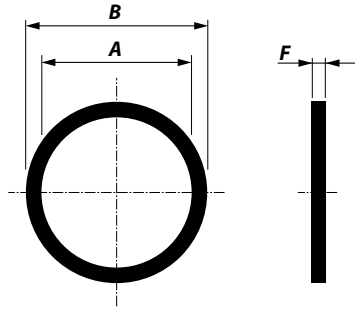

Article No.	Size (Inch)	NB (mm)	Pipe (mm)	A (mm)	B (mm)	F (mm)	Weight (kg)
213350030010	1	25	34.5	35	90	2	0.1
213350030013	1.25	32	43.2	43	100	2	0.1
213350030015	1.5	40	49.1	49	105	2	0.1
213350030020	2	50	61.1	61	120	2	0.1
213350030025	2.5	65	77.1	77	140	2	0.2
213350030030	3	80	90.0	90	150	2	0.2
213350030040	4	100	115.4	116	175	2	0.2
213350030050	5	125	141.2	142	210	2	0.2
213350030060	6	150	166.6	167	240	2	0.3
213350030080	8	200	218.0	218	290	2	0.3
213350030100	10	250	269.5	270	355	2	0.3
213350030120	12	300	321.0	321	400	2	0.3
213350030140	14	350	358.1	358	445	2	0.4
213350030160	16	400	409.0	409	510	2	0.4
213350030180	18	450	460.0	460	565	2	0.4
213350030200	20	500	511.0	511	620	2	0.5
213350030240	24	600	613.0	613	730	2	0.8
213350030280	28	700	715.0	715	840	2	0.8
213350030320	32	800	817.0	817	950	2	0.8
213350030360	36	900	919.0	919	1050	2	1
213350030400	40	1000	1021.0	1021	1160	2	1

CHARACTERISTICS

Material Gaskets are produced out of graphite

Range Diameter range from 34.5 mm up to 1021 mm

Thickness 2 mm, with an option for 3 and 4 mm

Temperature The maximum allowable temperature is 600°C

M-SIZES BOLTS & NUTS



M-sizes bolts & nuts vs. flange types & sizes

Size (Inch)	NB (mm)	Pipe (mm)	DIN2573 PN6	DIN2576 PN10	DIN86044	ANSI#150	JIS 5K	JIS 10K
1	25	33.4	M10 x 40	M12 x 40	-	M12 x 60	M10 x 40	M16 x 60
1.25	32	42.2	M12 x 50	M16 x 50	-	M12 x 60	M12 x 50	M16 x 60
1.5	40	48.3	M12 x 50	M16 x 50	-	M12 x 60	M12 x 50	M16 x 60
2	50	60.3	M12 x 50	M16 x 50	-	M16 x 60	M12 x 50	M16 x 60
2.5	65	76.1	M12 x 50	M16 x 50	-	M16 x 65	M12 x 50	M16 x 60
3	80	88.9	M16 x 60	M16 x 50	-	M16 x 65	M16 x 60	M16 x 60
4	100	114.3	M16 x 60	M16 x 50	-	M16 x 65	M16 x 60	M16 x 60
5	125	139.7	M16 x 60	M16 x 55	-	M20 x 70	M16 x 60	M20 x 70
6	150	168.3	M16 x 60	M20 x 60	-	M20 x 70	M16 x 60	M20 x 70
8	200	219.1	M16 x 60	M20 x 60	M20 x 60	M24 x 90	M20 x 70	M20 x 70
10	250	273.0	M16 x 60	M20 x 60	M20 x 60	M24 x 90	M20 x 70	M20 x 70
12	300	323.9	M20 x 60	M20 x 60	M20 x 60	M24 x 90	M20 x 70	M20 x 70
14	350	355.6	M20 x 60	M20 x 60	M20 x 60	M27 x 100	M24 x 80	M24 x 80
16	400	406.4	M20 x 60	M24 x 70	M20 x 60	M27 x 105	M24 x 80	M24 x 80
18	450	457.2	M20 x 60	M24 x 70	M20 x 60	M30 x 110	M24 x 80	M27 x 90
20	500	508.0	M20 x 60	M24 x 70	M20 x 60	M30 x 115	M24 x 80	M27 x 90
24	600	609.6	M24 x 70	M27 x 70	M20 x 70	-	M24 x 80	M30 x 105
28	700	711.2	M24 x 70	M27 x 70	M20 x 70	-	M24 x 80	M30 x 105
32	800	812.8	M27 x 75	M30 x 75	M20 x 70	-	M30 x 95	M30 x 105
36	900	914.4	M27 x 75	M30 x 75	M20 x 70	-	M30 x 95	M30 x 105
40	1000	1016.0	M27 x 75	M30 x 75	M20 x 70	-	M30 x 95	M36 x 120